

vtech[®]

User's Manual

Lil' Critters Crib-to-Floor Activity Center™



© 2013 VTech
Printed in China
91-002856-005 US CA

Dear Parent,

Ever notice the look on your baby's face when they learn something new through their own discovery? These self-accomplished moments are a parent's greatest reward. To help fulfill them, **VTech®** created the **Infant Learning®** series of toys.

These unique interactive learning toys directly respond to what children do naturally – play! Using innovative technology, these toys react to baby's interactions, making each play experience fun and unique as they learn age-appropriate concepts like first words, numbers, shapes, colors and music. More importantly, **VTech®**'s **Infant Learning®** toys develop baby's mental and physical abilities by inspiring, engaging and teaching.

At **VTech®**, we know that a child has the ability to do great things. That's why all of our electronic learning products are uniquely designed to develop a child's mind and allow them to learn to the best of their ability. We thank you for trusting **VTech®** with the important job of helping your child learn and grow!

Sincerely,

Your friends at **VTech®**

To learn more about the **Infant Learning®** series and other **VTech®** toys, visit www.vtechkids.com

INTRODUCTION

Thank you for purchasing the **VTech® Lil' Critters Crib-to-Floor Activity Center™** learning toy!

Keep your little critter discovering and exploring all day long with the **Lil' Critters Crib-to-Floor Activity Center™** by **VTech®**! Open and close windows for peek-a-boo animal surprises that develop motor skills. Piano keys and a spinning letter dial play songs and soothing melodies that help encourage first words. Straps attach to the crib or detach for play on the floor.

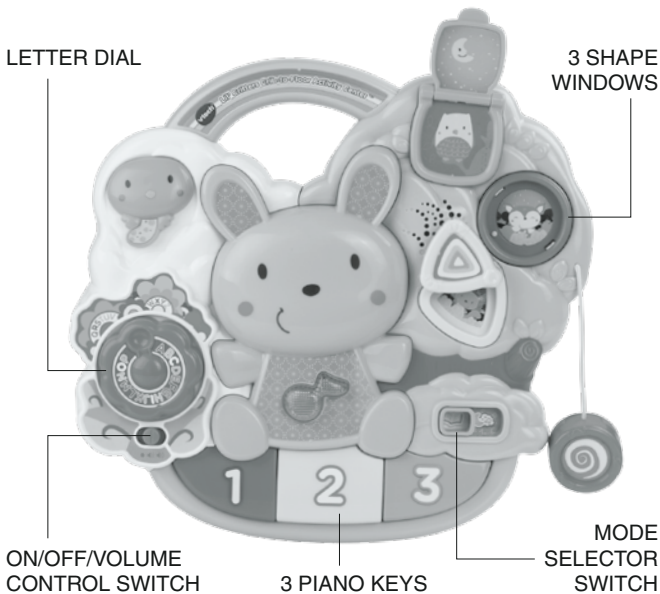

INCLUDED IN THIS PACKAGE

- One VTech® Lil' Critters Crib-to-Floor Activity Center™
- 2 crib attachment straps
- One instruction manual

WARNING:

All packing materials, such as tape, plastic sheets, packaging locks and tags are not part of this toy, and should be discarded for your child's safety.

ATTENTION:

Pour la sécurité de votre enfant, débarrassez-vous de tous les produits d'emballage tels que rubans adhésifs, feuilles de plastique, attaches et étiquettes. Ils ne font pas partie du jouet.

NOTE:

Please keep this instruction manual as it contains important information.

Unlock the packing locks:

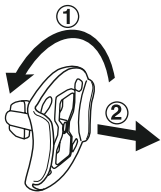

- ① Rotate the packing locks 90 degrees counter-clockwise.
- ② Pull out the packing locks.

INSTRUCTIONS

BATTERY INSTALLATION

1. Make sure the unit is turned **OFF**.
2. Locate the battery cover on the back of the unit. Use a coin or a screwdriver to loosen the screw.
3. Install 2 new 'AA' (AM-3/LR6) batteries following the diagram inside the battery box. (The use of new alkaline batteries is recommended for maximum performance.)
4. Replace the battery cover and tighten the screw to secure the battery cover.

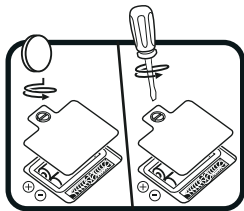



BATTERY NOTICE

- Use new alkaline batteries for maximum performance.
- Use only batteries of the same or equivalent type as recommended.
- Do not mix different types of batteries: alkaline, standard (carbon-zinc) or rechargeable (Ni-Cd, Ni-MH), or new and used batteries.
- Do not use damaged batteries.
- Insert batteries with the correct polarity.
- Do not short-circuit the battery terminals.
- Remove exhausted batteries from the toy.
- Remove batteries during long periods of non-use.
- Do not dispose of batteries in fire.
- Do not charge non-rechargeable batteries.
- Remove rechargeable batteries from the toy before charging (if removable).
- Rechargeable batteries are only to be charged under adult supervision.

ASSEMBLY INSTRUCTIONS

With the VTech® Lil' Critters Crib-to-Floor Activity Center™ safety comes first. To ensure your child's safety, adult assembly is required.

1. Place the unit in the crib. Slide the blue tab to the unlocked () position.
2. Following the arrow on the attachment strap, hook the larger end over the right side of the engraved area above the blue lock/unlock tab.
3. Loop the attachment strap around the spindle and thread it into the recessed slot. Feed the strap through the slot and pull it tight around the crib rail.
4. Slide the blue tab to the locked () position.

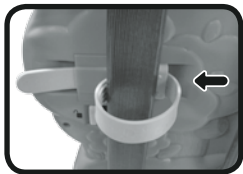
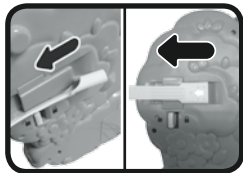
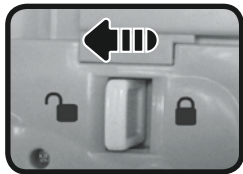

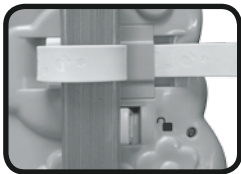

- Repeat the above steps for the second strap.
- Pull slightly on the unit to make sure the straps are securely fastened. The unit should be tight against the crib rails. For extra security, tie the yellow cord to the nearest spindle. Please check the unit regularly to ensure it is still secure.
- The unit can also be used outside of the crib as a floor toy. For your child's safety, please remove the attachment straps and store them in a safe location.



GETTING STARTED

1. ON/OFF/VOLUME CONTROL SWITCH

To turn the unit **ON**, slide the **ON/OFF/VOLUME CONTROL SWITCH** to the low volume () or high volume () position. To turn the unit **OFF**, slide the **ON/OFF/VOLUME CONTROL SWITCH** to the **OFF** () position.



2. MODE SELECTOR SWITCH

Slide the **MODE SELECTOR SWITCH** to the Learning Mode (📖) or Music Mode (🎵) position.

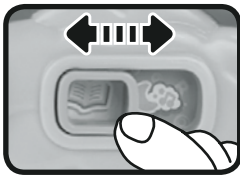

3. AUTOMATIC SHUT-OFF

To preserve battery life, the **VTech® Lil' Critters Crib-to-Floor Activity Center™** will automatically power-down after approximately 60 seconds without input. The unit can be turned on again by pressing any button.

ACTIVITIES

1. Slide the **on/off/volume control switch** to turn the unit on. You will hear a song, a playful phrase or a song and a short tune depending on the selected mode. The light will flash with the sound.
2. Press the **piano keys** to learn numbers and colors in the Learning Mode and hear five minutes of music in the Music Mode. The light will flash with the sound.



3. Open or close the **shape windows** to learn shapes, animal names, sing-along songs and fun sounds in the Learning Mode. In the Music Mode you will hear melodies and short tunes. The light will flash with the sound.
4. Turn the **letter dial** to hear a sing-along song, a fun sound or a random melody depending on the selected mode. The light will flash with the sound.

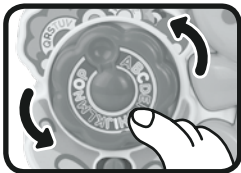
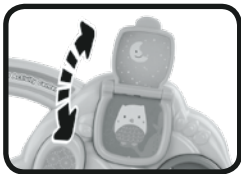

MELODY LIST

1. Sing a Song of Sixpence
2. Here We Go Round the Mulberry Bush
3. Listen to the Mocking Bird
4. Ring Around the Rosy
5. Humpty Dumpty
6. Good Morning Merry Sunshine
7. Teddy Bear's Picnic
8. Ta-Ra-Ra Boom De Ay
9. Pop! Goes the Weasel
10. Where Has My Little Dog Gone?
11. ABC Tumble Down D
12. Oh! Susanna
13. Happy Farmer
14. Hickory Dickory Dock
15. Girls and Boys Come Out to Play

16. Toyland
17. Are You Sleeping?
18. Daisy Bell
19. Diddle Diddle Dumpling
20. Alouette
21. Rock-a-Bye Baby
22. Three Little Kittens
23. Mary Had A Little Lamb
24. Twinkle, Twinkle Little Star
25. Baa Baa Black Sheep

SONG LYRICS

SONG 1

Hello, hello, it's time to play!
Can you find the animals who are hiding?
Can you slide the animal that's flying?

SONG 2

Hush little baby, it's time to rest.
Dreamland is near, quiet time is here.

SONG 3

Peek-a-boo little squirrel, peeking out for all to see.

SONG 4

Peek-a-boo little fox, I see you hiding in the tree.

SONG 5

Peek-a-boo little owl, perched up high in the big green tree.

SONG 6

A,B,C,D,E,F,G,
Learn some letters, sing with me!

CARE & MAINTENANCE

1. Keep the unit clean by wiping it with a slightly damp cloth.
2. Keep the unit out of direct sunlight and away from any direct heat source.
3. Remove the batteries when the unit will not be in use for an extended period of time.
4. Do not drop the unit on hard surfaces and do not expose the unit to moisture or water.

TROUBLESHOOTING

If for some reason the program/activity stops working or malfunctions, please follow these steps:

1. Please turn the unit **OFF**.
2. Interrupt the power supply by removing the batteries.
3. Let the unit sit for a few minutes, then replace the batteries.
4. Turn the unit **ON**. The unit should now be ready to play again.
5. If the product still does not work, replace with an entire set of new batteries.

If the problem persists, please call our Consumer Services Department at 1-800-521-2010 in the U.S. or 1-877-352-8697 in Canada, and a service representative will be happy to help you.

For information on this product's warranty, please call VTech® at 1-800-521-2010 in the U.S. or 1-877-352-8697 in Canada.

IMPORTANT NOTE:

Creating and developing **Infant Learning** products is accompanied by a responsibility that we at **VTech®** take very seriously. We make every effort to ensure the accuracy of the information, which forms the value of our products. However, errors sometimes can occur. It is important for you to know that we stand behind our products and encourage you to call our Consumer Services Department at 1-800-521-2010 in the U.S. or 1-877-352-8697 in Canada, with any problems and/or suggestions that you might have. A service representative will be happy to help you.

Note:

This equipment has been tested and found to comply with the limits for a Class B digital device, pursuant to Part 15 of the FCC Rules. These limits are designed to provide reasonable protection against harmful interference in a residential installation. This equipment generates, uses and can radiate radio frequency energy and, if not installed and used in accordance with the instructions, may cause harmful interference to radio communications. However, there is no guarantee that interference will not occur in a particular installation. If this equipment does cause harmful interference to radio or television reception, which can be determined by turning the equipment off and on, the user is encouraged to try to correct the interference by one or more of the following measures:

- Reorient or relocate the receiving antenna
- Increase the separation between the equipment and receiver
- Connect the equipment into an outlet on a circuit different from that to which the receiver is connected
- Consult the dealer or an experienced radio/TV technician for help

Caution: Changes or modifications not expressly approved by the party responsible for compliance could void the user's authority to operate the equipment.

THIS DEVICE COMPLIES WITH PART 15 OF THE FCC RULES. OPERATION IS SUBJECT TO THE FOLLOWING TWO CONDITIONS:
(1) THIS DEVICE MAY NOT CAUSE HARMFUL INTERFERENCE, AND
(2) THIS DEVICE MUST ACCEPT ANY INTERFERENCE RECEIVED, INCLUDING INTERFERENCE THAT MAY CAUSE UNDESIRE OPERATION.

CAN ICES-3 (B)/NMB-3(B)



**CLASS 1
LED PRODUCT**